

0.1 ±0.1	Ra
0.2 ±0.2	▽
0.3 ±0.3	▽
0.5 ±0.5	▽
0.8 ±0.8	▽
1.6 ±1.6	▽
2.5 ±2.5	▽
3.2 ±3.2	▽
4.0 ±4.0	▽
5.0 ±5.0	▽
6.3 ±6.3	▽
8.0 ±8.0	▽
10 ±10	▽
12.5 ±12.5	▽
16 ±16	▽
20 ±20	▽
25 ±25	▽
31.5 ±31.5	▽
40 ±40	▽
50 ±50	▽
63 ±63	▽
80 ±80	▽
100 ±100	▽
125 ±125	▽
160 ±160	▽
200 ±200	▽
250 ±250	▽
315 ±315	▽
400 ±400	▽
500 ±500	▽
630 ±630	▽
800 ±800	▽
1000 ±1000	▽

HAITIMA CORPORATION
 P.O.BOX 34-36 TAIPEI
 Tel:+886-2-26585800

E-mail:haitima@seed.net.tw
 TAIWAN R.O.C.
 www.haitima.com.tw
 Fax:+886-2-26582266

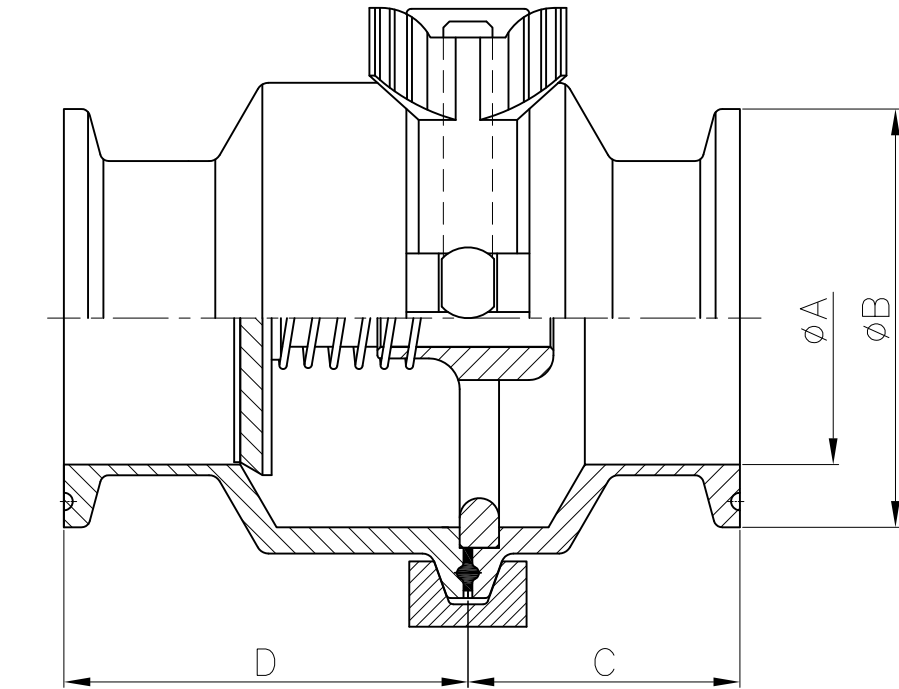

SIZE	A	B	C	D	Weight(kg)
1/2"	9.5	25.2	28.5	39.5	0.4
3/4"	15.8	25.2	28.5	39.5	0.5
1"	22.1	50.5	34	48	1.1
1-1/2"	34.8	50.5	36	48	1.2
2"	47.5	64	36	48	1.4
2-1/2"	60.2	77.5	36	48	1.8
3"	72.9	91	36	48	2.3
4"	97.6	119	47	54	4.7

unit:mm

M HAITIMA CORPORATION
 Ball Valves

CHECK BY	DRAWING BY	DATE	SPECIFICATION	3A Middle Clamp Weld End Check Valve
	Ray	Jan.21.2013	MATERIAL	SS 316(L)
			PROCESS/Nr.	
			UNIT / SCALE	mm

△			
△			
△			
Revise	Description	Date	Approve
DRAWING NO.		CV-CS004 - 13	