

Ra	0.2	▽▽▽
	1.6	▽▽
	6.3	▽
	25	▽
GENERAL TOLERANCE	±0.1 0.5~5 6~30 31~120 121~320 321~1000	±0.2 ±0.3 ±0.5 ±0.8

HAITIMA CORPORATION  
P.O.BOX 34-36 TAIPEI  
Tel:886-2-26585800

E-mail: haitima@ms8.hinet.net  
TAIWAN R.O.C. www.haitima.com.tw  
Fax:886-2-26582266

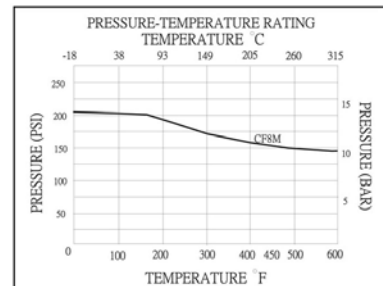
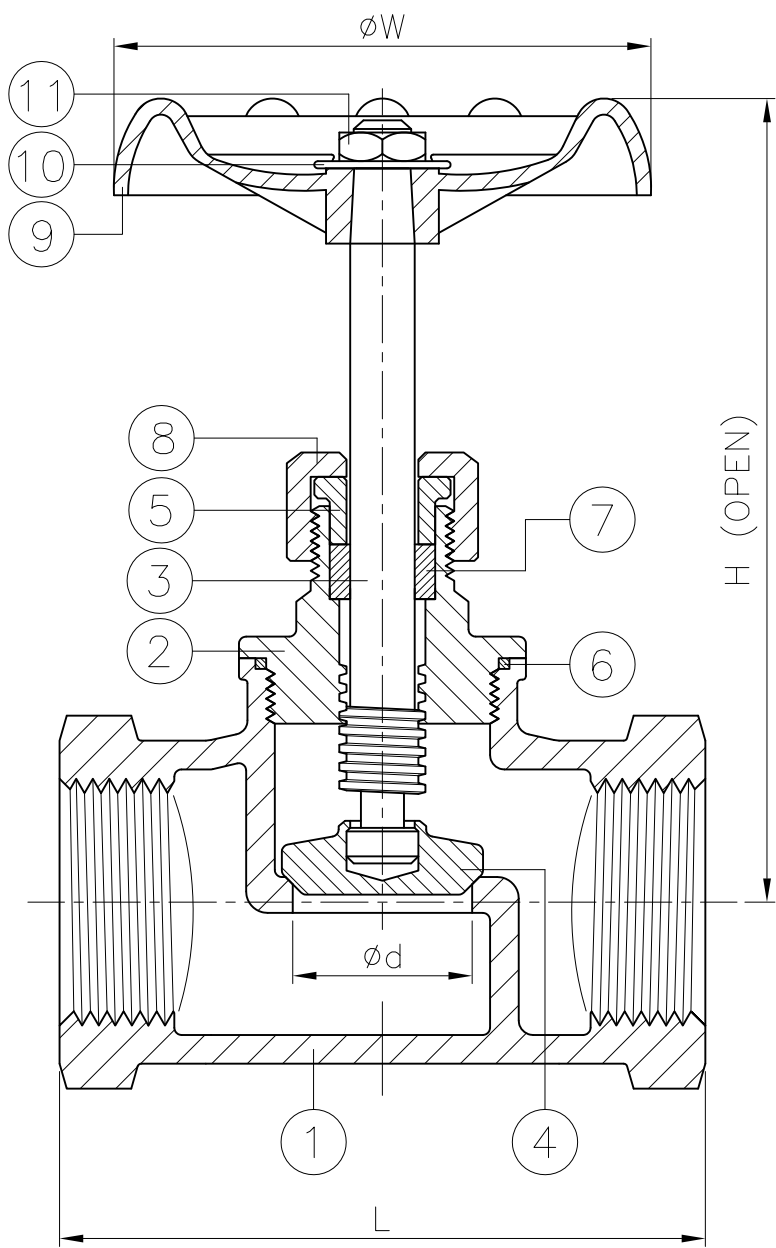

DN	d	L	H	W	Weight(kg)
8	15	66	102	62	0.5
10	15	66	102	62	0.5
15	15	66	102	62	0.4
20	16	68.5	102	62	0.5
25	19	78.3	104	74	0.6
32	24	86	120	95	1.1
40	32	98	142	95	1.4
50	38	110.5	157	100	2.1

unit:mm

NPS	d	L	H	W	Weight(lb)
1/4"	0.59	2.6	4.02	2.44	1.1
3/8"	0.59	2.6	4.02	2.44	1.1
1/2"	0.59	2.6	4.02	2.44	0.9
3/4"	0.63	2.7	4.02	2.44	1
1"	0.75	3.08	4.09	2.91	1.4
1-1/4"	0.94	3.39	4.72	3.74	2.3
1-1/2"	1.26	3.86	5.59	3.74	3.1
2"	1.5	4.35	6.18	3.94	4.6

unit:in

ITEM	PARTS	MATERIAL
1	BODY	ASTM A351-CF8M
2	BONNET	
3	STEM	SS 316
4	DISC	
5	GLAND	ASTM A351-CF8M
6	GASKET	PTFE
7	PACKING	
8	GLAND NUT	ASTM A351-CF8M
9	HANDWHEEL	FC-150
10	WASHER	SS 304
11	NUT	

△			
△			
△			
Revise	Description	Date	Approve

DRAWING NO. **2028001XY - 13**



CHECK BY	DRAWING BY	DATE	SPECIFICATION	Screwed End Globe Valve 200 WOG
	Ray	Jan.24.2013	MATERIAL	CF8M
			PROCESS/Nr.	
			UNIT / SCALE	mm

